

VAPORGENIE® PIPE OWNERS GUIDE

Congratulations and thank you for purchasing The VaporGenie, the world's first vaporizing pipe! With proper use, your VaporGenie will provide you with years of satisfying vaporization. The VaporGenie is guaranteed against product defects for life.

How the VaporGenie Pipe Works

The VaporGenie glass bat has a ceramic filter above the bowl area. The ceramic filter is designed to thoroughly mix heat from flame with cold, ambient air, producing an air stream with a temperature of about 275-350 F. This air stream is hot enough to vaporize plant essences, but not hot enough to burn.

VaporGenie Pipe Materials

- **The Glass Bat** body is made of Schott heavy wall borosilicate glass. The metal components (sliding door, retaining ring, support coil) are made of stainless steel.
- **Ceramic Filter** is made of high-purity silicon carbide (silicon + carbon), one of the most inert and heat-resistant ceramics known. It does not contain metals and so will not contaminate your vapor. The ceramic filter does not burn or deteriorate, and will never need replacement.

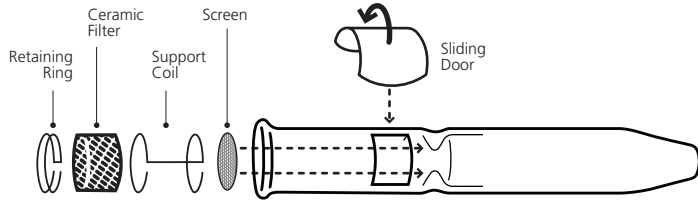

Maintenance

- It is necessary to occasionally clean the glass and replace the screen. To do this, remove the retaining ring by pulling on it with tweezers or small hook. The ceramic filter, support coil, and screen will fall out. Also remove the sliding door. Liquid cleaners (soapy water or alcohol) or glass pipe cleaner solutions can be used to clean the glass.
- Never touch the flame to the ceramic. The ceramic filter is delicate; do not scrape or crush it. If soot is deposited on the ceramic, it can be burned off using a propane torch. See our website for details.

SERVICE & PARTS: www.VAPORGENIE.com

How to Use your VaporGenie

The VaporGenie pipe uses heat from the flame of a butane lighter. Use a lighter that produces an ordinary yellow candle flame. Torch style lighters (pinpoint blue flame) burn too hot and will tend to overheat the glass. Because "flint" sparks contain toxic rare earth metals, we strongly recommend using piezo/electronic ignition lighter rather than a flint lighter. (See our website for details on lighters). Use a flame about 1-inch (25mm) tall.

- 1) Slide door open.
- 2) Completely fill the bowl with shredded smoking blend, but do not pack tightly. Completely filling bowl is necessary because with a partially-filled bowl, hot air can flow around your smoking blend instead of through it. For proper vaporization, hot air must flow through your smoking blend.
- 3) Slide door closed.
- 4) Inhale slowly and constantly while supplying a 1-inch flame to the flame intake. **One draw should be about 6-8 seconds long.** It is important to inhale constantly. Hold the lighter so that 1/4 - 1/2 of the flame is drawn down inside the top. **DO NOT touch the flame to the ceramic filter.**

Flavor and mouth sensations indicate the temperature within the pipe. Pay close attention to these sensations, and regulate the temperature by adjusting the flame size, flame application or inhalation speed.

- If you are not inhaling anything, then the temperature is too low, OR the bowl is not full enough. Temperature can be increased by: 1) inhaling more slowly or 2) applying more flame. Inhaling **SLOWER** creates **HOTTER** temperatures.
- If you taste a burned flavor, then the temperature is too high, or your blend is finished. Temperature can be decreased by: 1) inhaling faster, or 2) applying less flame. Inhaling **FASTER** creates **COOLER** temperatures.
- It is normal to exhale slightly visible vapor/mist.

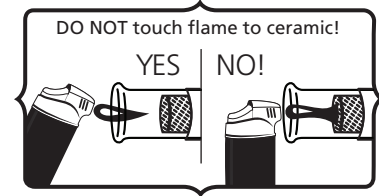

Contacting the flame to the ceramic will form soot that can eventually clog the filter, rendering it unusable. Deposited soot can be cleaned from the ceramic by heating it red hot with a torch. See our website for details.

CUSTOMER SERVICE: www.VAPORGENIE.com